

# THE BACKWATERS OF CHEAT LAKE

## HOMESITE VIEWS:

YEAR ROUND LAKE VIEWS

PANORAMIC MOUNTAIN

SEASONAL LAKE VIEWS &  
PANORAMIC MOUNTAIN

NOTE: Boundary lines &  
acreage subject to change

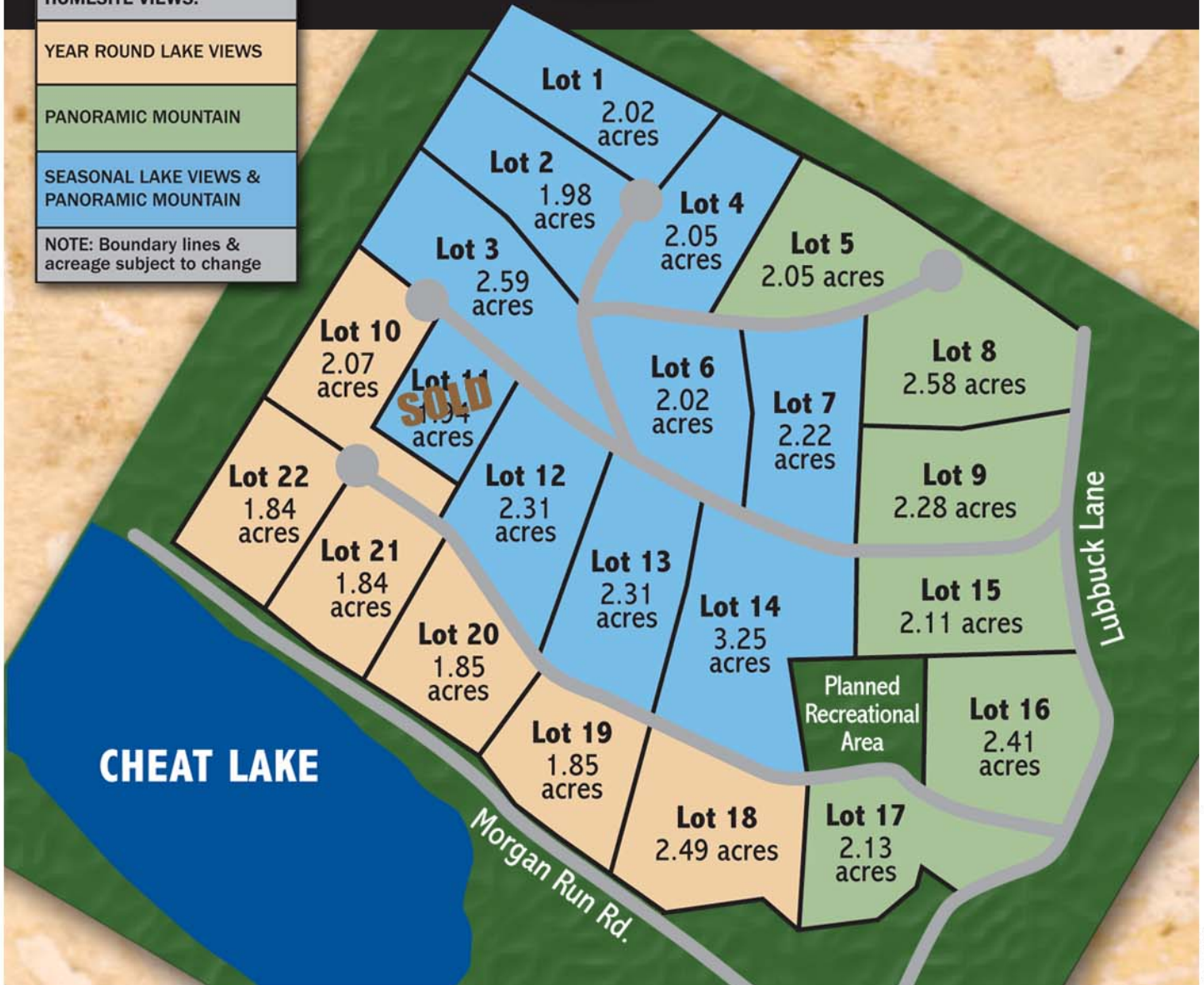

© 2008 www.morgantowns.com

[www.thebackwatersofcheatlake.com](http://www.thebackwatersofcheatlake.com)



For a personal tour or  
more information, contact:

**R. SCOTT SUMMERS**  
Associate Broker

(cell) 304.282.3463  
(office) 292.2895 or 594.0115  
(email) rsummers@mountain.net

A Development By:  
**WINDSTAR HOLDINGS LLC**  
R. Scott Summers, Manager

*Directions:*  
Cheat Lake Exit of I-68 to 857 North  
2 Miles to Morgan Run Road  
1 Mile to Lubbucket Lane